

# Cinderella<sup>®</sup>



## CINDERELLA TRAVEL Model Cinderella Travel

 Made in Norway



**Cinderella Travel Owner's Manual**

## CONTENTS

<b>Safety</b> .....	3
Gas in caravan/motor homes.....	3
General information about safety in Cinderella Travel.....	3
<b>Technical information</b> .....	4
Description .....	4
<b>How the toilet works</b> .....	6
<b>Use (operation)</b> .....	6
Before use .....	6
Using the toilet .....	6
General information about the use of Cinderella Travel .....	6
Emptying the ash container .....	7
Winter use .....	8
Light signals.....	8
<b>Maintenance</b> .....	9
Cleaning the ash container.....	9
Cleaning the bowl.....	9
Cleaning the catalytic converter.....	10
<b>Troubleshooting</b> .....	11
<b>Resetting the thermal switch</b> .....	12
<b>Warranty</b> .....	13

## SAFETY

**READ INSTRUCTIONS CAREFULLY! PLEASE KEEP THIS OWNER'S MANUAL FOR FUTURE USE.**

### **GAS IN CARAVAN/MOTOR HOMES**

Use and storage of gas requires caution. Check bottle, hoses, tubes and attachments before use.

People live in close proximity on campsites and use combustible materials, stoves, grills and other sources of ignition. Therefore, it is recommended that you familiarize yourself with the campsite's safety rules and make sure you have a working smoke detector and fire extinguisher in your caravan.

Propane tanks should always be upright and must never be exposed to abnormal heat or strong solar heat. Be aware of potential propane leaks. Remember that propane is heavier than air. In the event of leakage, the gas will therefore remain at floor level inside the vehicle. Gas leaks can make air explosive and can be ignited by open flames, smouldering tobacco or an electric spark.

Find leaks by brushing soapy water onto hoses and pipe fittings. When you open up for the gas, bubbles will form where the gas is leaking. If a leak is identified, the gas supply must be shut off. Do not use the toilet until the leak has been fixed.

Turn off the gas at the tank when the unit is not in use, and remember to disconnect the regulator during long periods of absence.

It is recommended that you install a gas detector in the housing unit if one has not already been fitted.

The vehicle can be driven while the toilet is incinerating. For safety, we recommend installing a gas pressure regulator with crash sensor close to the gas bottle or gas tank.

Always keep the gas appliance in good condition, but do not attempt to repair any damage or defects yourself.

In the event of a fault, contact your supplier.

### **GENERAL INFORMATION ABOUT SAFETY IN CINDERELLA TRAVEL**

Cinderella Travel is equipped with various safety features:

The gas supply is always shut off via an electronically controlled valve when the toilet is not in incineration mode.

The system monitors the incineration and a flame sensor detects whether there is fire in the burner. If the burner fails to ignite, the gas supply will be shut off and an alarm will be triggered using sound and lights.

The flame sensor shuts off the gas supply if the flame goes out due to blow-back in the burner or an imbalance in the gas/air ratio.

The flap in the bowl and hatch to the incineration chamber will not open until the toilet lid is closed. This prevents access to the incineration chamber.

The incineration is shut off when the toilet lid is open.

If the temperature inside the toilet chamber becomes too high, the thermal switch is released and incineration is halted. The thermal switch must be reset manually before the toilet can be used again. See section on troubleshooting.

The outer shell of the toilet is made of a fire-retardant composite material.

Incineration is disabled if the ash container is not in the correct position.

The fan in the toilet is programmed to run until the temperature inside the incineration chamber has cooled down sufficiently.

The incineration chamber and exhaust pipe are insulated with material capable of withstanding high temperatures.

All toilets are tested prior to distribution.

# TECHNICAL INFORMATION

Weight	20 kg
Height	540 mm
Seat height	490 mm
With	390 mm
Depth	590
Capacity	3-4 visits per hour
Standby Power Consumption	0.005 Amp
Peak load	4.0 Amp
Power consumption (incineration)	1.3 Amp
Gas consumption	140-180 g per incineration
Exhaust fan	12V DC
Gas	Propane (30 mBar pressure)
Electrical power supply	12V DC / 4 Amp (11-14.4V)
Maximum burner effect	2,7 kWh

**! WARNING!**

Do not use the toilet more frequently than the maximum capacity indicated. This will lead to the incineration chamber overflowing, smelling or leaking and can cause damage to the toilet.

## DESCRIPTION

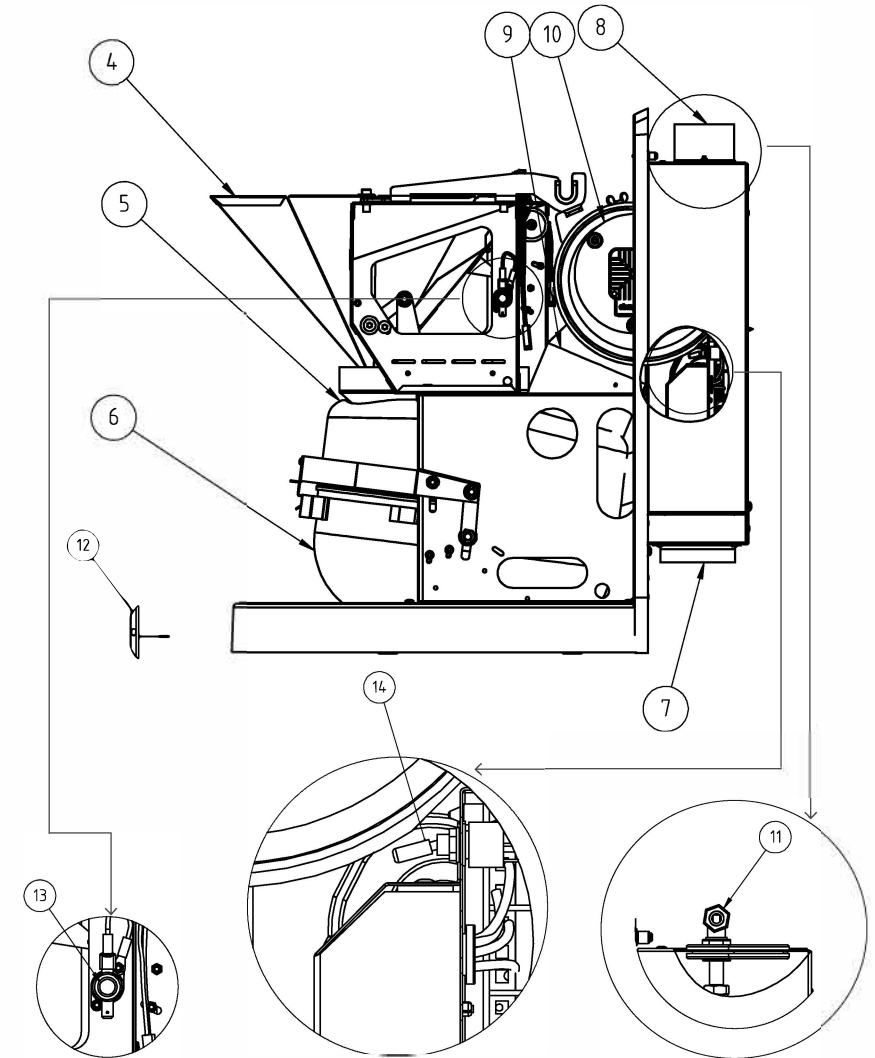
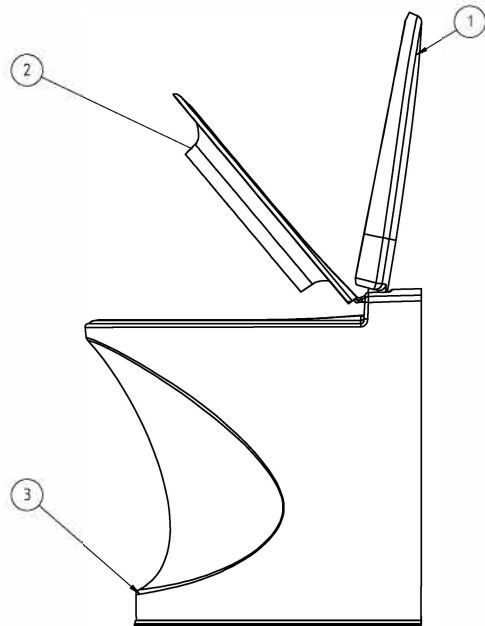

1	Lid	8	Exhaust
2	Seat	9	Catalytic converter
3	Shell	10	Fan
4	Bowl	11	Gas connection
5	Incineration chamber	12	Control panel
6	Ash container	13	High temperature protection
7	Air inlet	14	Main power switch

## HOW THE TOILET WORKS

When the toilet visit is over, the bowl liner with its contents is released into the incineration chamber. High heat and air are added causing the liquid to evaporate and the remaining waste is burnt and turned into ash. Residual heat and fumes are emitted via the exhaust pipe. A catalytic converter prevents unpleasant odours.

## USE (OPERATION)

### BEFORE USE

1. Make sure the power supply is connected.
2. Make sure the propane is connected.
3. Use only propane / LPG.

### USING THE TOILET

1. Lift up the lid and the seat. The red light flashes and the green light is illuminated. The exhaust fan will start automatically.
2. Place the bowl liner inside the bowl, ensuring that the liner's seam is in line with the "seam" of the bowl. Remember to use a new bowl liner for each visit (Illustration 1).
3. Put the seat down. The toilet is ready for use (Illustration 2).
4. Use the toilet. For small amounts of waste, add a cup of water to make the liner heavy enough to slide down into the incineration chamber.
5. Close the toilet lid.
6. Press the start button (Illustration 3). When the hatch closes, the incineration begins. The toilet is then ready for use again.
7. A yellow light on the control panel indicates that incineration is in progress. The light will illuminate throughout the duration of the incineration process.

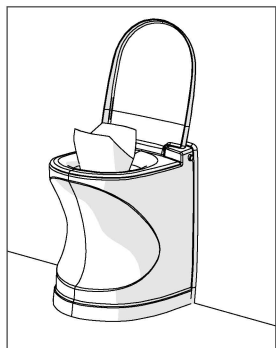

Illustration 1

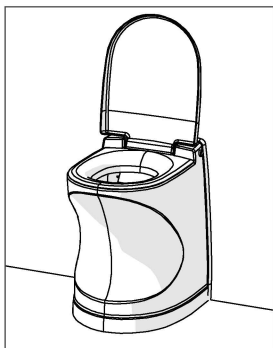

Illustration 2

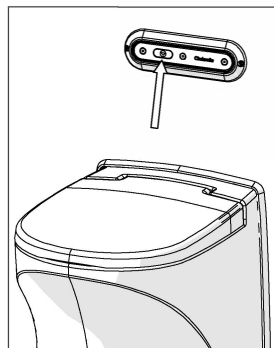

Illustration 3

### GENERAL INFORMATION ABOUT THE USE OF CINDERELLA TRAVEL

Make sure the ash container is in the correct position.

1. Always place a bowl liner in the bowl before use. The toilet lid must always be closed when the toilet is not in use.
2. Incineration cannot commence until the lid is down in closed position.
3. If the lid is opened, any active incineration will stop. The toilet is then ready for use. After each visit, the incineration is re-started by pressing the start button on the control panel. The toilet will automatically detect when the incineration has finished.
4. The yellow light on the control panel switches off when the incineration ends. The fan stops when the temperature in the incineration chamber has cooled down sufficiently (1-1.5 hours after incineration ends).

### EMPTYING THE ASH CONTAINER

It is recommended that you empty the ash container once a week or when the signal (alternating yellow and red flashing lights on the control panel) to empty it appears after approximately 70 incineration cycles.

1. Wait until the toilet has cooled down and the fan has stopped. Do not turn the 12V power off.
2. Pull the toilet's shell out from its connection to the rear wall. To assist you in pulling the shell, hook your fingers around the "buttons" (Illustration 4).
3. The shell will automatically move out and up with the help of the inside lifting mechanism, and then remain in the service position.
4. Loosen the locking spring and lift the latch at the front of the ash container (Illustration 5).
5. Pull out the ash container. Remove the insert from the ash container and empty out the ash (Illustration 6).
6. Clean off any urine salts and burnt-on residue from the insert. Read how to clean the insert in the most effective way in the section on "Maintenance".
7. Place the insert back in the ash container.
8. Push the ash container all the way in so that it can be locked into position.
9. Pull the latch back into position and click the ash container into place.
10. Lower the shell by pressing both hands against the back part of the top of the toilet lid (Illustration 7). Make sure that the frame in the toilet wall (the white trim) surrounds the edge of the shell.

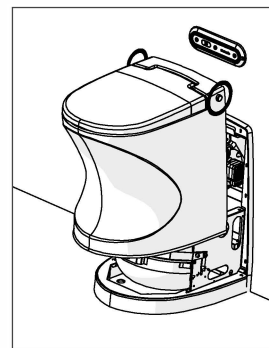

Illustration 4

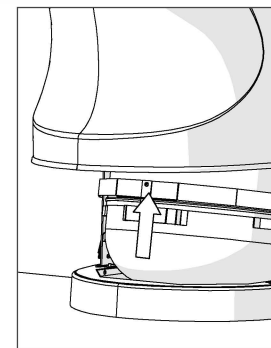

Illustration 5

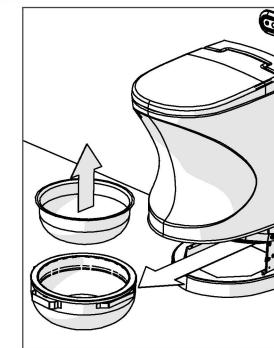

Illustration 6

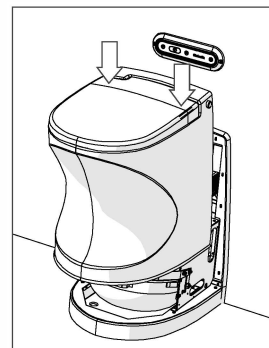
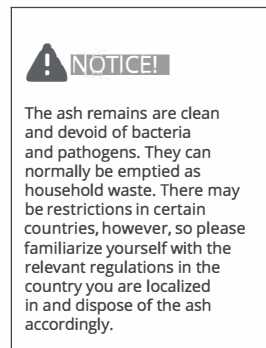

Illustration 7



**WINTER USE**

In the event that the unit will be used in an area where snow is likely to build up on the roof of your motor home/caravan, please use the exhaust extension provided. This will ensure that the exhaust does not get blocked with snow, which would reduce air circulation and impair incineration.

NOTE! Remember to remove the extender during transport.

**LIGHT SIGNALS**

There are three lights on the control panel: red, yellow and green. When one of these lights is on, it either indicates which operating mode the toilet is in or highlights an error (see separate section about troubleshooting).

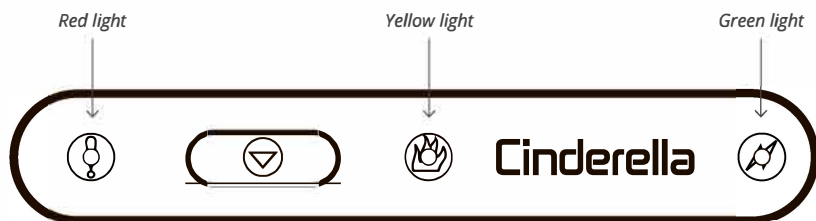

LIGHT TYPE	LIGHT SIGNAL	STATUS
● Green light	Light stays on	Toilet connected to 12 V power
● Yellow light	Light stays on	Incineration in progress. Incineration will stop if the toilet lid is opened, and the toilet is then ready for use.
● Red light	Flashing	Toilet lid is open.
● Red and yellow light	Flashes alternately	It is recommended that you empty the ash container.

**MAINTENANCE**

Cinderella operates in an extreme environment, with high temperatures, acids and exhaust fumes. This results in the need for preventive maintenance of the ash container, pipes, fan and catalytic converter. It is recommended that you use an authorized caravan workshop to carry out maintenance in connection with regular servicing of the caravan/motor home.

**HOWEVER, MOST OF THE MAINTAINANCE YOU CAN DO YOURSELF:****CLEANING THE ASH CONTAINER****! NOTICE!**

- The ash container must only be emptied and cleaned when the toilet has cooled down sufficiently.
- Do not use detergents containing chlorine or other abrasive contents, as this can corrode the insert and damage the catalytic converter.

**To be carried out every time you empty the ash container** (see description on page 7).

1. Remove the ash container.
2. Remove the insert from the ash container and empty out the ash.
3. Pour warm water into the insert to dissolve burnt-on residue and urine salts. Leave the water to stand for one hour.
4. Pour out the water and brush off any residue from the insert. Do not scrape with any metal items as this can damage the surface.

**CLEANING THE BOWL****! NOTICE!**

- The toilet must have cooled down.
- Do not use detergents containing chlorine or other abrasive contents.
- Do not use any utensils that could scratch the metal surface on the bowl.

**To be carried out as needed or after every third time the ash container is emptied.**

1. Open the toilet lid. Press and hold down the start button until the hatch to the bowl opens.
2. The hatch to the bowl will remain open until the toilet lid is closed again. A safety function ensures that the hatch can only be placed in the open position when the toilet has cooled down sufficiently.
3. Clean the bowl with a soft cloth (Illustration 8). Alternatively, you can use paper towels and then drop them into the incineration chamber after cleaning. When finished, close the toilet lid. The hatch to the incineration chamber will then close.

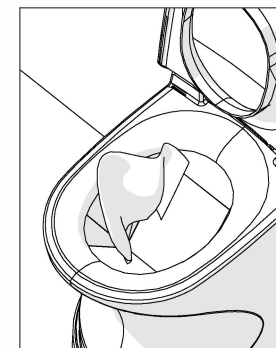

Illustration 8



## CLEANING THE CATALYTIC CONVERTER

To be carried out if you suspect poor incineration or a cycle of 30 days' use has been completed.

1. Wait for the toilet to cool down and the fan to stop.
2. Pull the toilet shell out from the rear wall. The shell will automatically move out and up with the help of an inside lifting mechanism and remain in the service position.
3. Lift the shell completely off the lifting mechanism (Illustration 9).
4. Loosen the screw on the fan cover (Illustration 10).
5. Remove the fan cover. Loosen it from the retaining screw by turning it slightly backwards. Then lift it out (Illustration 11).
6. Remove the catalyst pipe with the catalytic converter (Illustration 12).
7. Rinse the catalytic converter in warm water (Illustration 13).
8. Reassemble the parts in reverse order. Make sure that the catalyst pipe is put in the same position as it was before disassembly.
9. Place the toilet chamber back onto the lifting mechanism.
10. Run a dry incineration cycle (by pressing the start button) to dry out the catalytic converter.

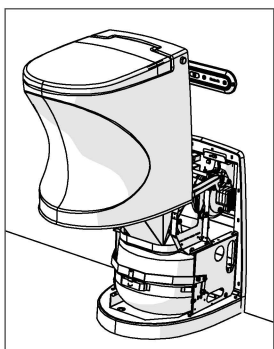

Illustration 9

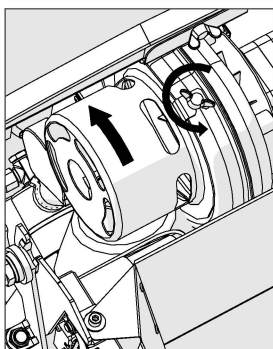

Illustration 10

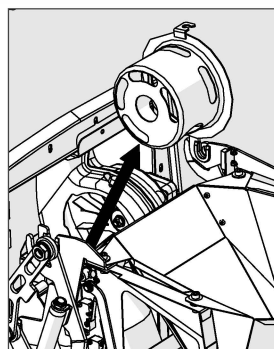

Illustration 11

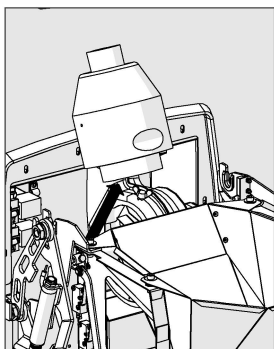

Illustration 12

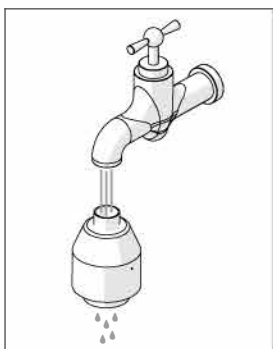

Illustration 13

## TROUBLESHOOTING

	Red light	Yellow light	Green light	signal	diy
Problem with exhaust fan.	Flashing		Flashing	10 beeps	<ol style="list-style-type: none"> <li>1. Reset the toilet.</li> <li>2. Open and close the toilet lid.</li> <li>3. Start incineration.</li> <li>4. If error recurs, contact dealer/service.</li> </ol>
Problem with gas fan.	Flashing	Flashing	Flashing	10 beeps	<ol style="list-style-type: none"> <li>1. Reset the toilet.</li> <li>2. Open and close the toilet lid.</li> <li>3. Start incineration.</li> <li>4. If error recurs, contact dealer/service.</li> </ol>
Problem with gas burner after 3 attempts to ignite it.		Flashing		Continuous beeps	<ol style="list-style-type: none"> <li>1. Check that the gas is connected.</li> <li>2. Connect it if necessary and reset the toilet.</li> <li>3. Reset the thermal switch if needed.</li> <li>4. Open and close the toilet lid.</li> <li>5. Start incineration.</li> <li>6. If error recurs, contact dealer/service.</li> </ol>
Hatch is jammed.	Flashing			10 beeps	<p><b>When toilet is warm:</b></p> <ol style="list-style-type: none"> <li>1. Press the start button multiple times without inserting a new bowl liner.</li> <li>2. Open the lid after each attempt. If this does not work, wait for the toilet to cool down (fan has stopped).</li> </ol> <p><b>When toilet is cold:</b></p> <ol style="list-style-type: none"> <li>1. Open the toilet lid and press start. The lid opens.</li> <li>2. Remove the cause of the blockage.</li> </ol>
Ash container is not in correct position.	Flashing	Flashing		3 beeps	Place ash container into correct position.
Error in the temperature sensor		Flashing	Flashing	Continuous	Try to reset the toilet. If this does not work, contact workshop or dealer.
Thermal switch released.		Flashing		Continuous	Reset thermal switch (see separate section).
The ash container is full. The toilet is disabled for use.	Illuminated	Illuminated		Continuous	Empty and clean ash container.
No lights, no sound.					Check that the caravan's/motor home's main switch is on. Check that 12 V voltage is connected.
Burnt smell outside caravan/motor home.					Clean catalytic converter. Ensure that the exhaust pipe is open.
Low voltage < 11.0 V.			Flashing		Resolve the error on the 12 V supply from the car/caravan.
Minimum allowed voltage < 10.5 V. The gas supply is shutoff.			Flashing (after 1.5 min)	10 beeps, recurrent	Resolve the error on the 12 V supply from the motor home/caravan.
Critically low voltage. Immediate shut-down.				10 beeps	Resolve the error on the 12 V supply from the motor home/caravan.



Reset the toilet by holding the start button down for 8 seconds. You can release the button when you hear a long beep.

## RESETTING THE THERMAL SWITCH

If the temperature in the chamber becomes too high, a thermal switch will be released. To reset it, stand in front of the toilet and pull the toilet shell out from the rear wall. The thermal switch is on the right side (Illustration 14). Press the button. When you hear and feel a click (tactile feedback), the thermal switch has been reset. If there is no tactile feedback, there are other reasons for the yellow light.

## SERVICE

Cinderella Travel operates in an acidic environment and the incineration chamber reaches high temperatures. A service will therefore be required at some point. Remember that preventive maintenance will delay the need for a service significantly.

If the toilet requires a service, contact your dealership and provide the serial number of your toilet so that the workshop is aware of the model and which spare parts may be required to repair your toilet. Please visit [www.cinderellaeco.com](http://www.cinderellaeco.com) for a list of our service workshops.

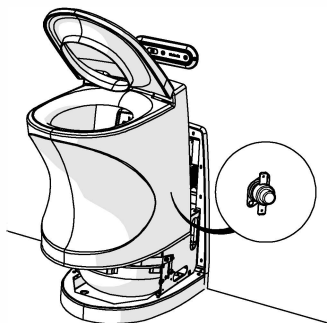

Illustration 14

## WARRANTY



### What does this Warranty cover?

This warranty covers defects in materials or workmanship in your Cinderella Travel Incineration Toilet on the terms, for the period and subject to the exceptions set out below.

### What does this Warranty not cover?

This warranty does not cover normal wear and tear, or damage caused by accidents, force majeure, abuse, misuse, failure to follow manufacturer directions or improper maintenance. Consequential and incidental damages are not recoverable under this warranty. Cinderella Eco Group does not apply an "on-site" warranty. This means that the toilet must be transported to an authorized dealer who can do the service. If this is not possible, a transport cost may be charged by the dealer.

### How long does the Warranty apply?

This warranty lasts for a period of three (3) years from the original date of purchase.

### How do I arrange a service?

To arrange a service, contact your motorhome/caravan dealer or visit an Authorised Service Provider. Available service options are dependent upon the country in which service is requested.

You may be required to furnish proof of purchase details when making a claim under this warranty. For further warranty information, please refer to our web page: [www.cinderellaeco.com](http://www.cinderellaeco.com)

### Cinderella Eco Group

Sjøvikvegen 67  
NO-6475 Midsund  
Norway  
[www.cinderellaeco.com](http://www.cinderellaeco.com)

